

NOTE:

- 1) THIS GROUP OF COMPONENTS IS OFFERED AS AN OPTIONAL MEANS OF INSTALLING THE SK6 GYRO USING BONDING ADHESIVE INSTEAD OF A DIRECT BOLT -IN METHOD. SEE BOND-IN INSTALLATION GUIDELINE DWG. # 90399 FOR BOLT TORQUE SPECIFICATIONS AND OTHER IMPORTANT INFORMATION.
- 2) HARDWARE IS INCLUDED: M12-1.75 X 65mm LG. CLASS 8.8 HEX HEAD CAP SCREWS, SPLIT LOCK WASHERS AND FLAT WASHERS. SEAKEEPER RECOMMENDS USING LOC-TITE 243 BLUE THREAD SEALANT DURING ASSEMBLY. TORQUE TO 65 FT/LBS. (88 Nm)

REV NO.	ECN NO.	ZONE	DESCRIPTION	DATE	APPRVD.
---------	---------	------	-------------	------	---------

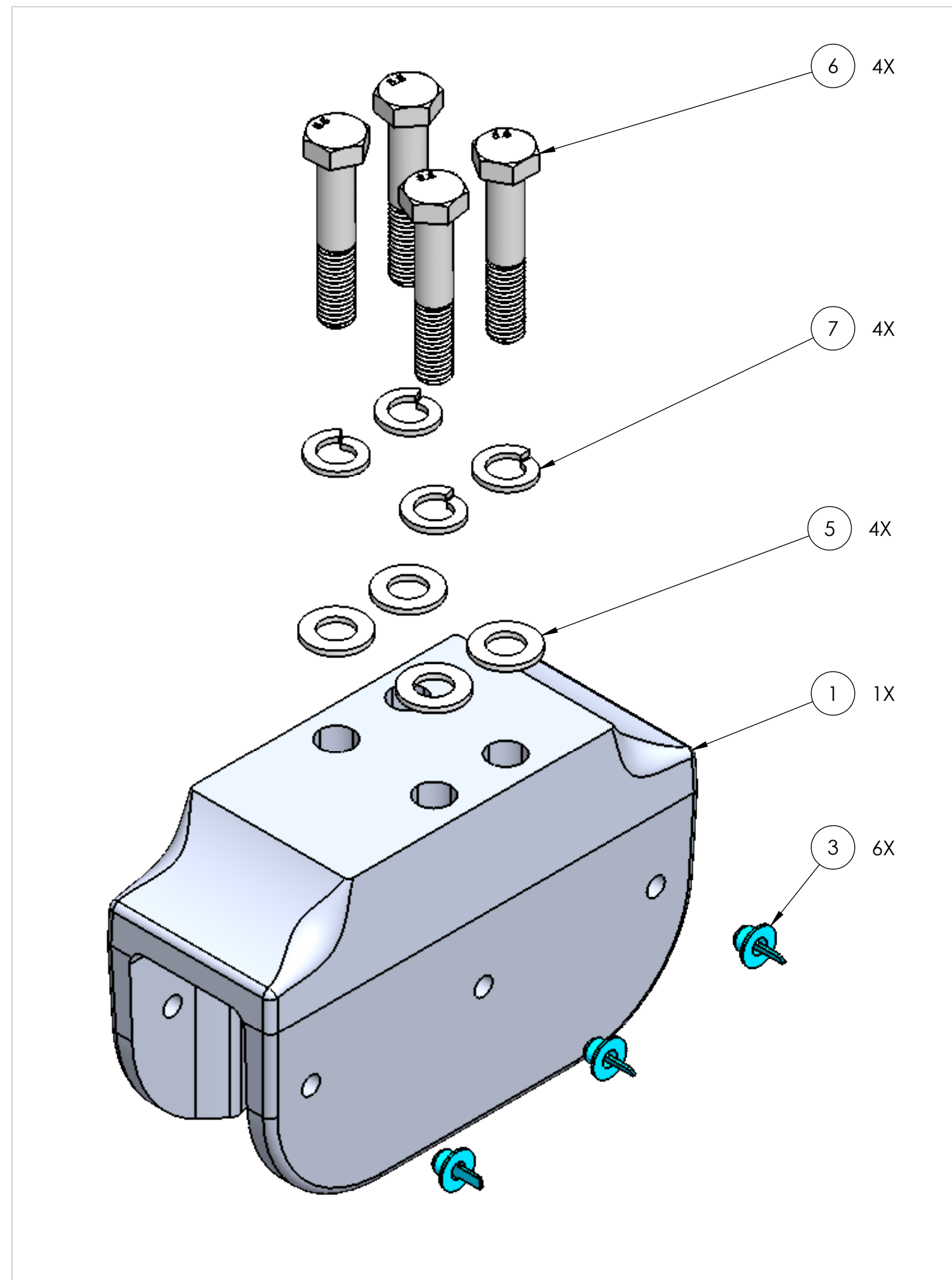

4X
 KIT INCLUDES 4X THE PARTS SHOWN
 TO BE INTALLED AT EACH MOUNTING FOOT
 OF THE GYRO

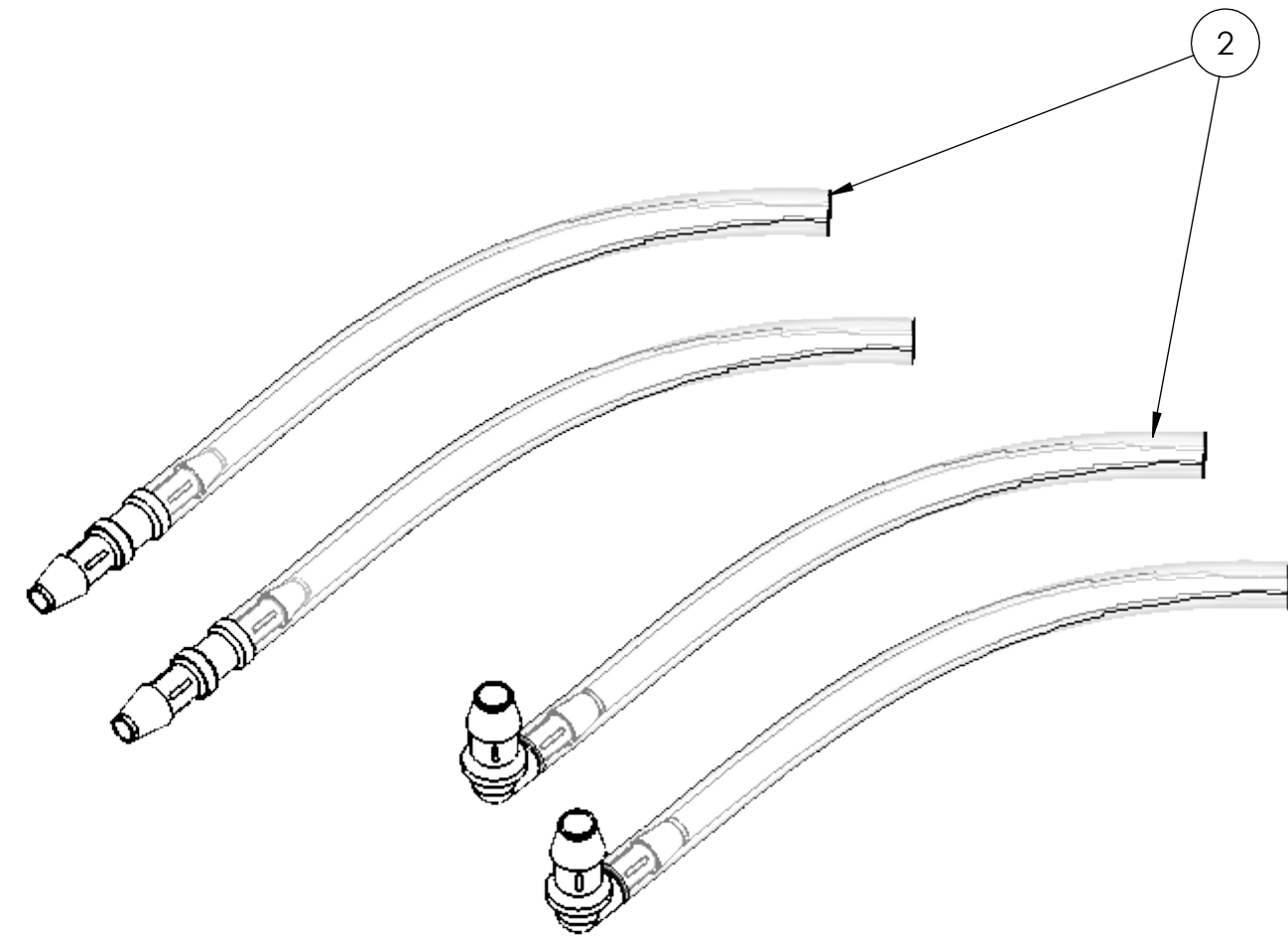

ITEM NO.	PART NUMBER	DESCRIPTION	QTY.
7	60428	WASHER, SPLIT LOCK, M12	16
6	60350	SCREW, HX HD CAP, M12X1.75, 65mm LG, GRADE 8.8	16
5	60252	WASHER, FLAT M12 DIN125 8.8	16
4	40370	SK9 SADDLE DECAL SHEET	1
3	40264	PLUG, ADHESIVE INJECTION HOLE, BLUE	24
2	11281	ADHESIVE INJECTION NOZZLE FITTING AND TUBE KIT	2
1	10978	SK5 FINISH MACHINED SADDLE	4

PROPRIETARY AND CONFIDENTIAL THE INFORMATION CONTAINED IN THIS DRAWING IS THE SOLE PROPERTY OF SEAKEEPER INCORPORATED. ANY REPRODUCTION IN PART OR AS A WHOLE WITHOUT THE WRITTEN PERMISSION OF SEAKEEPER IS PROHIBITED.		 Seakeeper Inc. 44425 Pecan Court, Suite 151 California, MD 20619	
WEIGHT - LBS : --- MATERIAL : ---		NAME : SK6 BOND-IN KIT	
DRAWN : WHK ENG APPR : PROD APPR :		DATE : 12 JUL 2016 DWG NUMBER : 90401 REV. NO. : 1 SHEET NO. : 1 OF 1	