

# Exhaust Systems and Accessories

Composite Silencers and Separators

## Lift Silencers - Side Angle In Top Out

Part No.	Reference	Lift Silencers - Side Angle In Top Out						Weight kg		
		A	B	C	D	E	F		G*	
H001454	HAT015	2 3/8	60	270	275	60	68	175	30	3.6
H001455	HAT020	3	76	270	275	76	68	175	30	3.9
H001458	HAT025	3 1/2	89	305	324	91	84	184	30	5.5
H001459	HAT030	3 1/2	89	266	275	89	50	152	30	4.4
H001460	HAT035	4	102	480	324	130	70	300	35	7.8
H001461	HAT040	4	102	305	324	85	70	184	35	5.7
H001462	HAT043	4 1/2	114	480	324	135	70	300	35	7.9
H001463	HAT045	5	127	480	324	140	70	300	35	8.7
H001464	HAT050	6	152	370	446	200	100	222	35	11.2
H010302	HAT055	8	203	521	548	201	122	323	55	18.6
H017158	HAT060	10	254	660	650	289	148	374	55	29.6

Drawings and dimensions are for guidance. Alternative sizes and configurations available on request.

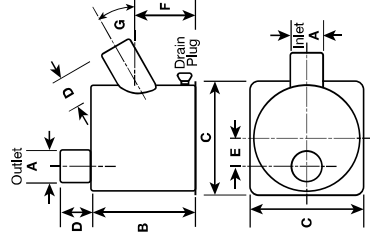

## Lift Silencers - End In End Out

Part No.	Reference	Lift Silencers - End In End Out						Weight kg
		A	B	C	D	E	F	
H001496	HEE005	1 1/2	38	250	178	55	141	1.7
H001497	HEE010	1 9/16	41	250	178	65	133	1.8
H001498	HEE020	1 3/4	45	250	178	65	133	1.8
H001499	HEE035	2	51	310	178	65	133	2.1
H001500	HEE040	2	51	420	254	65	195	4.2
H001501	HEE045	2	51	250	178	65	133	1.8
H001502	HEE060	2 3/8	60	310	254	75	195	3.7
H001503	HEE065	2 3/8	60	420	254	75	195	4.4
H001504	HEE070	2 1/2	63	420	254	75	195	4.4
H001505	HEE080	3	76	420	254	80	195	4.7
H001506	HEE090	3 1/2	89	465	254	89	188	5.2
H001507	HEE095	4	102	462	305	102	222	6.8
H001508	HEE100	4 1/2	114	462	305	114	220	7.0
H001509	HEE105	5	127	599	305	126	220	8.8
H001510	HEE110	6	152	640	346	152	260	11.4
H010303	HEE115	8	203	695	446	205	297	18.4

Drawings and dimensions are for guidance. Alternative sizes and configurations available on request.

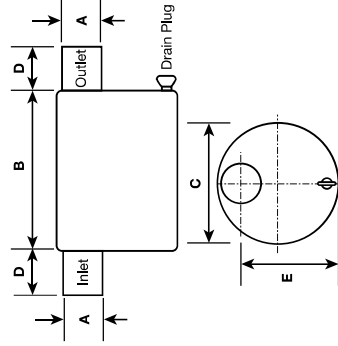

## In-line Round Body Silencers

Part No.	Reference	In-line Round Body Silencers						Weight kg		
		A1	A2	B	C	D	E			
H001524	HILR003	2 3/8	60	152	212	70	41	1.8		
H001525	HILR005	3	76	3	203	335	75	59	3.5	
H001526	HILR010	3 1/2	89	3.5	89	203	390	100	53	4.2
H001527	HILR015	4	102	4	102	254	465	102	68	6.4
H001528	HILR020	4 1/2	114	4.5	114	254	502	114	61	6.8
H001529	HILR025	5	127	5	127	254	546	127	55	7.9
H001530	HILR030	5	127	6	152	305	762	152	65	12.1
H001531	HILR035	6	152	6	152	305	661	152	65	11.4
H001532	HILR040	6	152	8	203	398	680	200	91	22.0
H001533	HILR045	8	203	8	203	395	880	201	88	23.0
H001534	HILR050	10	254	10	254	446	1092	254	87	32.0
H001535	HILR055	12	305	12	305	489	1308	305	87	41.0

Drawings and dimensions are for guidance. Alternative sizes and configurations available on request. All units are made to order and customisable.

## In-line Oval Body Silencers

Part No.	Reference	In-line Oval Body Silencers						Weight kg			
		A1	A2	B	C	D	E		F		
H001517	HILO005	5	127	520	140	225	385	118	10.8		
H001518	HILO006	5	127	6	152	640	150	225	385	10.6	
H001519	HILO010	6	152	6	152	640	150	225	385	10.5	
H001520	HILO012	6	152	8	203	928	203	270	420	12.2	
H001521	HILO015	8	203	8	203	876	203	270	420	16.3	
H001522	HILO016	8	203	10	254	758	203	295	465	17.1	
H001523	HILO020	10	254	10	254	1092	254	365	630	164	39.0

Drawings and dimensions are for guidance. Alternative sizes and configurations available on request. All units are made to order and customisable.

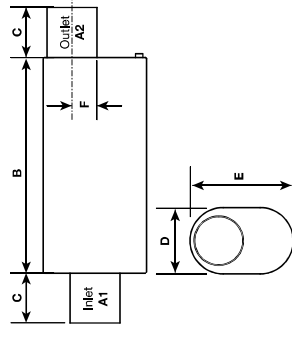

## Dual Chamber Silencers

Part No.	Reference	Dual Chamber Silencers						Weight kg
		A1	A2	B	C	D	E	
H008419	HDC025	4	102	4	102	600	446	446
H001488	HDC035	5	127	5	127	700	446	446
H001489	HDC040	5	127	6	152	800	446	446
H001490	HDC045	6	152	6	152	800	446	446
H001491	HDC050	6	152	8	203	800	446	446
H001492	HDC055	8	203	8	203	900	648	648
H001493	HDC060	8	203	10	254	900	650	650
H001494	HDC065	10	254	10	254	1000	650	650
H001495	HDC070	12	305	12	305	1000	650	650

Drawings and dimensions are for guidance. Alternative sizes and configurations available on request. All units are made to order and customisable.

