



AC Master

INVERTER CONTROL PANEL



USER AND INSTALLATION MANUAL

10000012750/01

1. Features

- Remote ON/OFF inverter operation with status LED indicator
- Optional Ignition Lockout Function or Remote Override Function

2. Specifications

Operating Temperature	0 – 40 °C, 32 – 104 °F
Storage Temperature	-30 – 70 °C, -22 – 158 °F
Stand-By Current Draw	< 40 mA
Input voltage AUX port (optional)	10.5 ~ 31.0 Vdc
Applicable Models	AC Master 700 / 1000 / 1500 / 2000 / 2500 / 3500

3. Product description

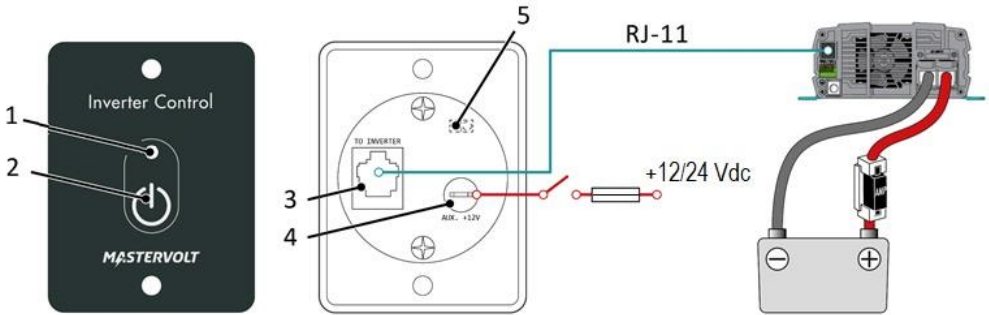

1	Status LED	—————	Inverter is ON
		Red, on	
		— — — — —	Ignition Lockout Function is activated
		Red, slow blinking	
2	ON/OFF button	—————	Remote Override Function is activated
		Red, fast blinking	
3	Remote port	Connects to the inverter with the RJ-11 cable	
4	AUX.	Optional connection to an auxiliary input wire, e.g. from the boat/vehicle's ignition switch. This is only required when Remote Override or Ignition Lockout is used.	
5	Jumper	The internal jumper is used to select one of the following optional features:	
		<ul style="list-style-type: none"> • Remote override (the jumper covers one pin; this is the default position): the AC Master switches ON when the control panel receives power on the auxiliary input. Typical use: switching on together with the electrical system. 	
		<ul style="list-style-type: none"> • Ignition lockout (the jumper covers both pins): the AC Master switches OFF when the control panel receives power on the auxiliary input. Typical use: switching off during engine start. 	

4. Installation

1. Check the contents of the delivery: Inverter Control Panel, 7,5 m (82 ft) RJ-11 cable, this manual.
2. Use the following screw hole and cutout dimensions for mounting of the panel.

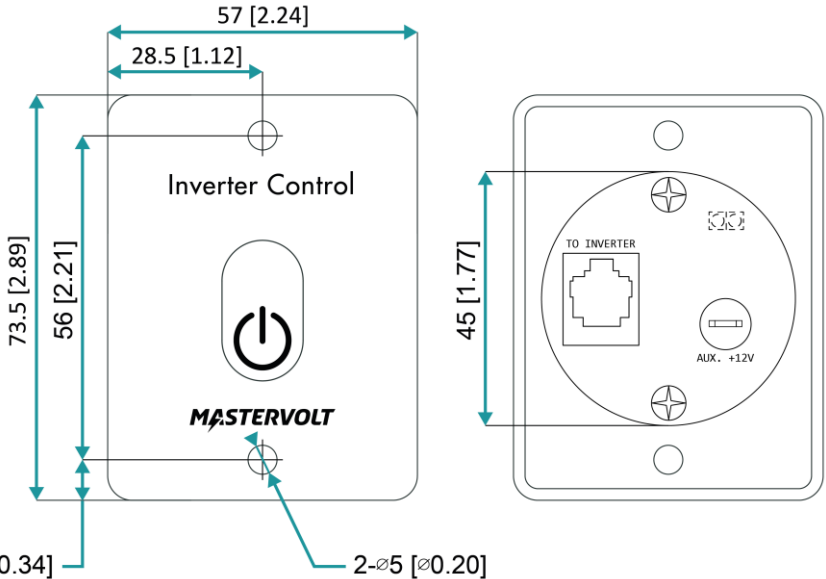

3. Optional:
 - a) In case of Ignition Lock: remove the circular back cover, by removing the two screws, and position the jumper over both pins. Replace the back cover.
 - b) In case of Remote Override or Ignition Lock: run a wire from the boat/vehicle's ignition switch to the AUX. input. **Note:** this wire must be protected by a fuse. See chapter 3.
4. Route the RJ-11 cable, provided with the panel, from the RJ11 port on the back of the AC Master Inverter Control Panel through the cutout.
5. Position the remote into the cutout and secure it with two screws.
6. First switch the AC Master unit OFF, then connect the RJ11 cable to AC Master unit. After that put its main switch in the "REMOTE" position, see user and installation manual of your AC Master unit.
7. Press the ON/OFF switch on the remote control panel to switch the AC Master unit ON.
8. Verify the status LED is on, both on the remote control panel and the AC Master unit.

5. Correct disposal of this product



This product is designed and manufactured with high quality materials and components, which can be recycled and reused. Please be informed about the local separate collection system for electrical and electronic products.

Please act according to your local rules and do not dispose of your old products with your normal household waste. The correct disposal of your old product will help prevent potential negative consequences to the environment and human health



Europe, Middle East & Africa

Customer Service

T: +31 (0) 20 34 22 100
E: info@mastervolt.com

Technical Support

T: +31 (0) 20 34 22 100
E: ts@mastervolt.com

Location & Shipping

Mastervolt
Snijdersbergweg 93
1105 AN Amsterdam
The Netherlands

Americas & Caribbean

Customer Service

T: +1 800 307 6702, Option 1
E: orderentry@marinco.com

Technical Support

T: +1 800 307 6702, Option 2
E: tsusa@mastervolt.com

Location & Shipping

Power Products, LLC
N85 W12545 Westbrook Crossing
Menomonee Falls, Wisconsin 53051
United States

Asia Pacific

Customer Service

T: +64 9 415 7261 Option 1
E: enquiries@bepmarine.com

Technical Support

T: +64 9 415 7261 Option 3
E: technical@bepmarine.com

Location & Shipping

BEP Marine
42 Apollo Drive
Rosedale, Auckland 0632
New Zealand