

REV	DESCRIPTION	DATE	APPVD

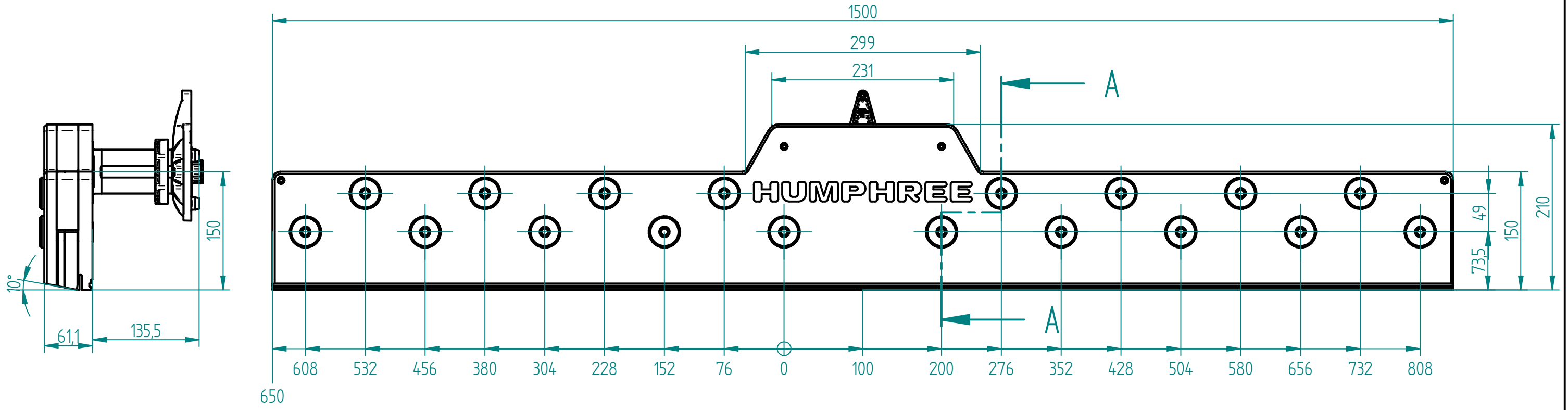

650

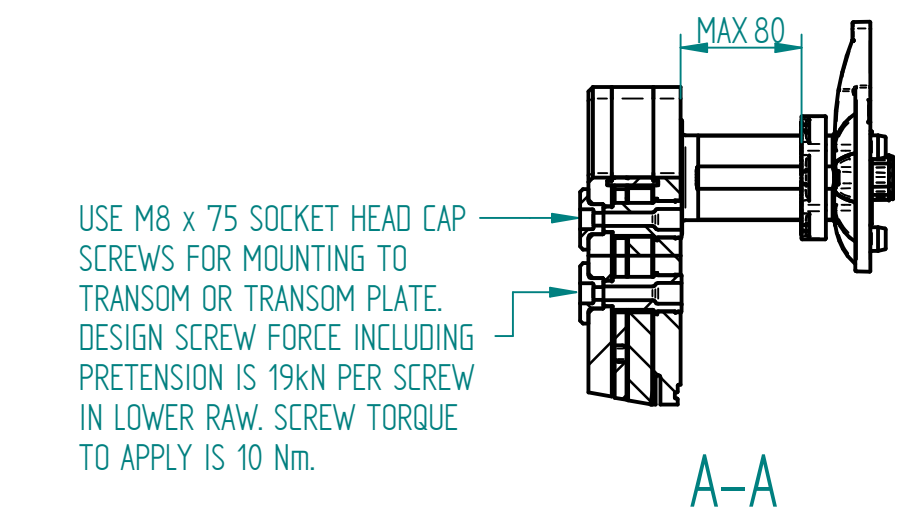
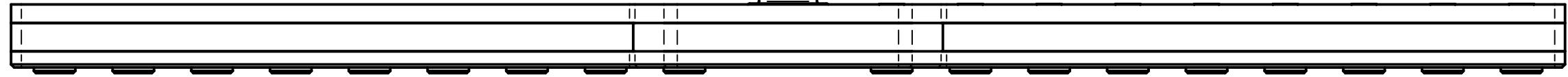
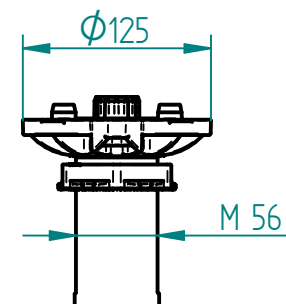

USE M8 x 75 SOCKET HEAD CAP SCREWS FOR MOUNTING TO TRANSOM OR TRANSOM PLATE. DESIGN SCREW FORCE INCLUDING PRETENSION IS 19kN PER SCREW IN LOWER RAW. SCREW TORQUE TO APPLY IS 10 Nm.

DATA

INTERCEPTOR SPAN
 INTERCEPTOR STROKE
 ENTRAINED WATER
 WEIGHT

1500 mm
 50 mm
 ~13 Liter
 ~17 kg

ITEM	QTY	DESCRIPTION	MATERIAL	SIZE	REFERENCE	REV
This document contains information of a proprietary nature and is delivered on the express condition that it is not to be disclosed, used or reproduced in whole or in part without the written consent of HUMPHREE AB.						
PROJECT			FILE NAME 020067-P01_H1500_SP_00_DIMENSIONS.dft			
TITLE INTERCEPTOR H1500-SP-00 DIMENSIONS					CLIENT	
HUMPHREE® www.humphree.com		DRAWN JÖ	CHKD CW	APPVD CW	SCALE 15	DATE 2021-02-04
SIZE A3	DRAWING NO 020067			SHEET 1 OF 1	REV P01	