

ATTENTION: BEFORE REMOVING THE SEAKEEPER, USE THIS DRAWING AS A CHECK LIST TO ENSURE ALL NECESSARY ITEMS ARE PRESENT WITHIN THE SHIPPING CRATE. (SOME ITEMS MAY BE PACKED UNDERNEATH THE COVER IN BAGS)

ITEMS NOT SHOWN TO SCALE, SOME ITEMS MAY APPEAR LARGER THAN NORMAL.

REV NO.	ECN NO.	ZONE	DESCRIPTION	DATE	APPRVD.
---------	---------	------	-------------	------	---------

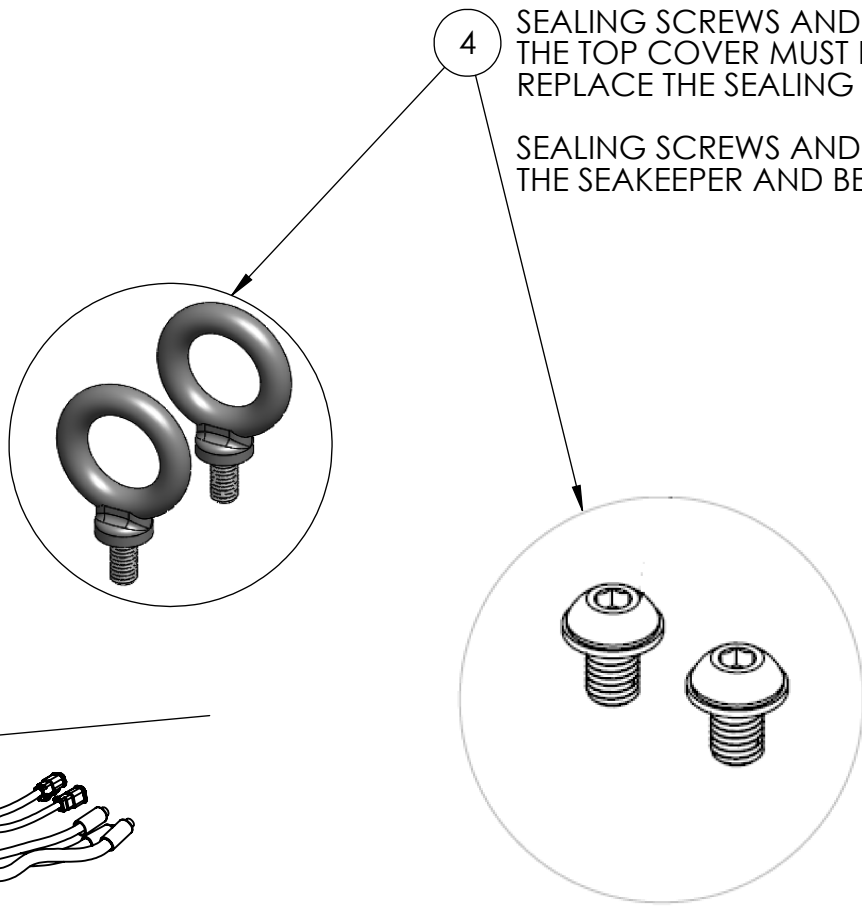
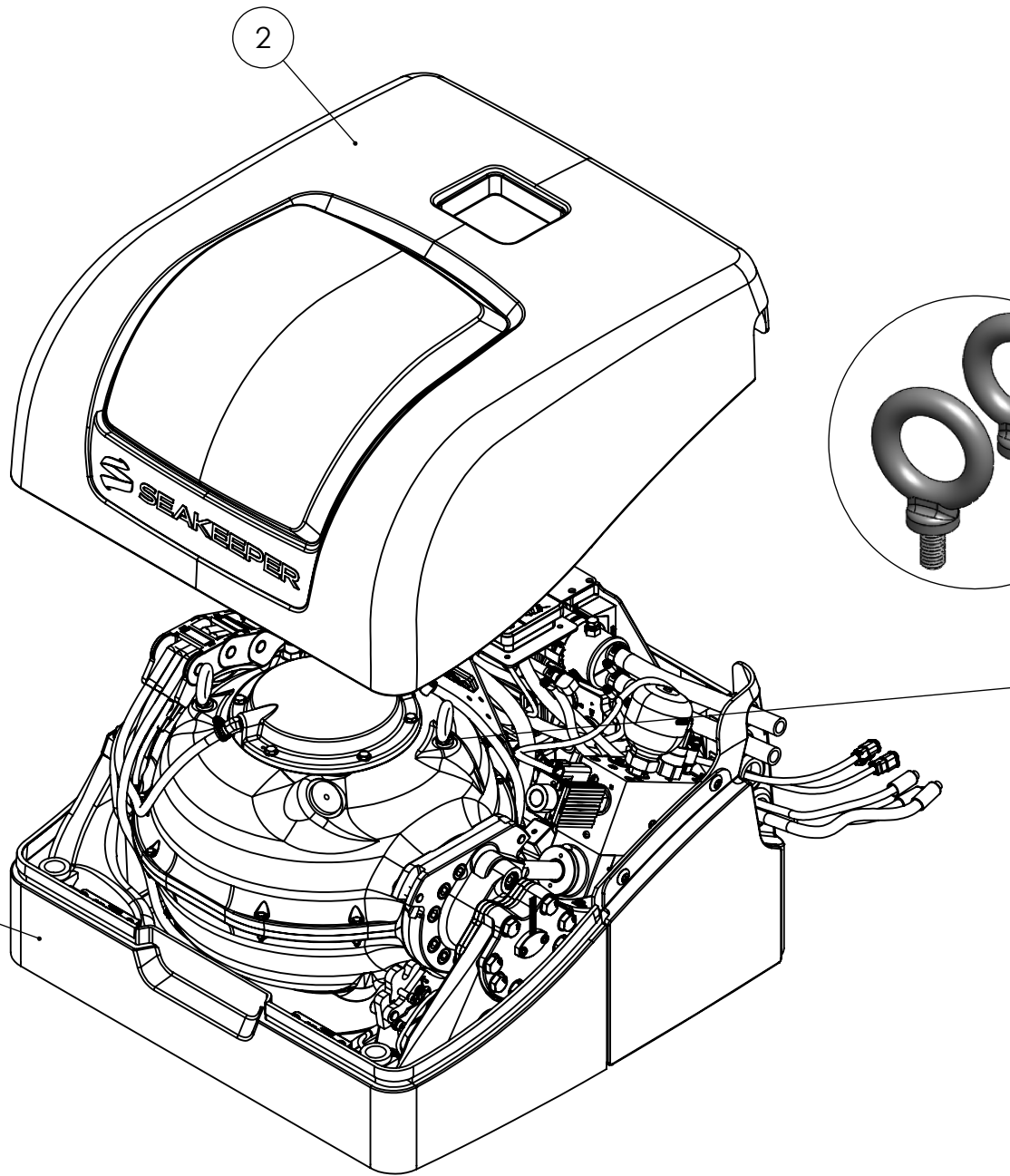

SPLICE CONNECTORS, AND MARINE HEATSHRINK ARE SUPPLIED WITH THE SEAKEEPER. TWO 2AWG SIZE, AND ONE 4AWG SIZE. REFERENCE 90511, SEAKEEPER 1 CABLE BLOCK DIAGRAM.

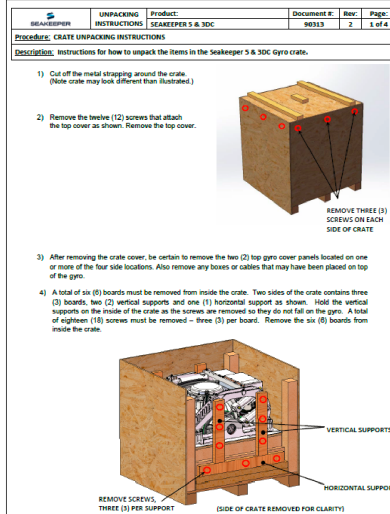
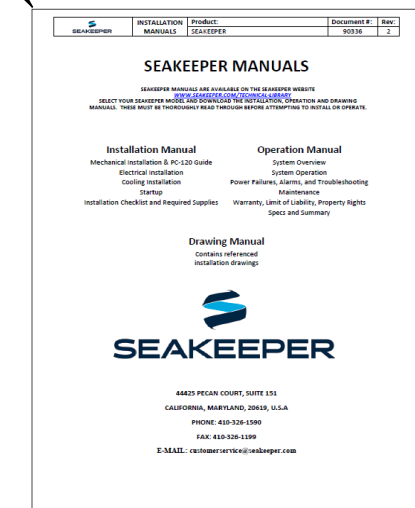
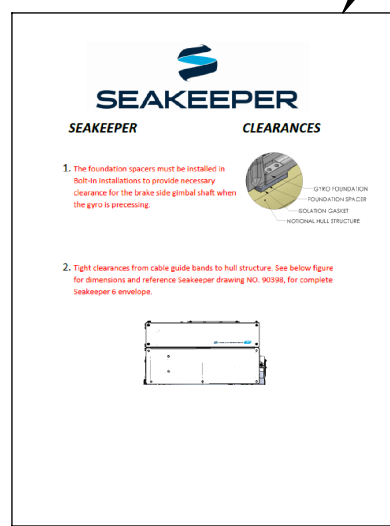
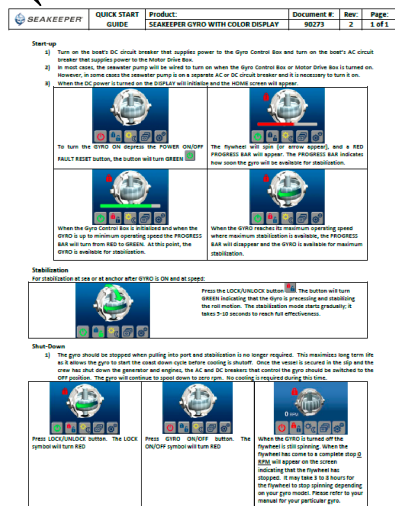
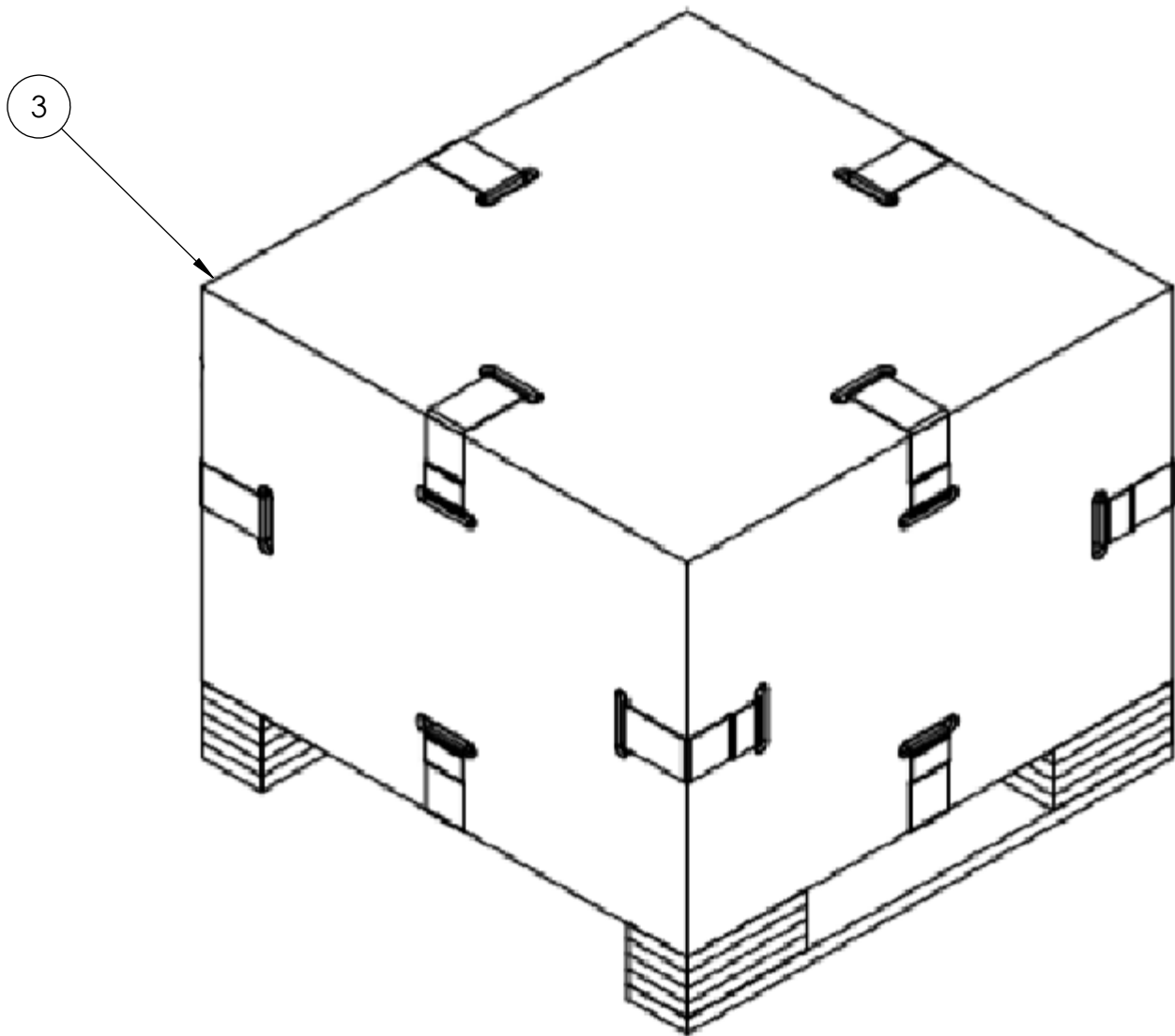
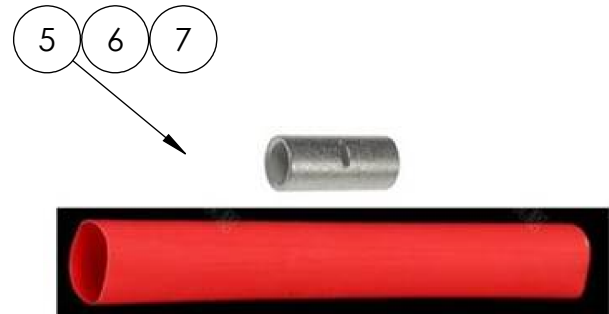

11	SEAKEEPER 1 CRATE UN-PACKING DOCUMENT	1	
10	SEAKEEPER 1 INSTALLATION CLEARANCE DOCUMENT	1	
9	ELECTRONIC MANUAL DOCUMENT	1	
8	SEAKEEPER 1 QUICK START GUIDE	1	
7	MARINE HEAT SHRINK	3	
6	4AWG WIRE SPLICE CONNECTOR	1	
5	2AWG WIRE SPLICE CONNECTOR	2	
4	LIFTING EYES, AND SEALING HARDWARE		
3	WASHER, WEDGE LOCK, M10, .45 ID X .83 OD		
2	SEAKEEPER 1 TOP COVER	1	
1	SEAKEEPER 1 GYRO ASSEMBLY	1	
ITEM NO. DESCRIPTION		QTY.	NOTE

WEIGHT - LBS :

MATERIAL:

PROPRIETARY AND CONFIDENTIAL

THE INFORMATION CONTAINED IN THIS DRAWING IS THE SOLE PROPERTY OF SEAKEEPER INCORPORATED. ANY REPRODUCTION IN PART OR AS A WHOLE WITHOUT THE WRITTEN PERMISSION OF SEAKEEPER IS PROHIBITED.

DRAWN: DDG DATE: 02AUG2019

ENG APPR: DATE:

PROD APPR: DATE:

SEAKEEPER
Seakeeper Inc. 44425 Pecan Court, Suite 151 California, MD 20619

NAME: SEAKEEPER 1 HARDWARE SCOPE OF SUPPLY

DWG NUMBER

90510

REV. NO. SHEET NO.

1 1 OF 1